

## 1990 Buick Reatta Turn Signal Switch Replacement Procedure

1. Disable the SIR system by turning off ignition, disconnecting the negative battery terminal, removing the SIR system fuse (#14 in panel), and then the yellow SIR connector up under the dash (located just near the hood release lever. It is bright yellow).

### 2. Remove Instrument Cluster Trim Plate

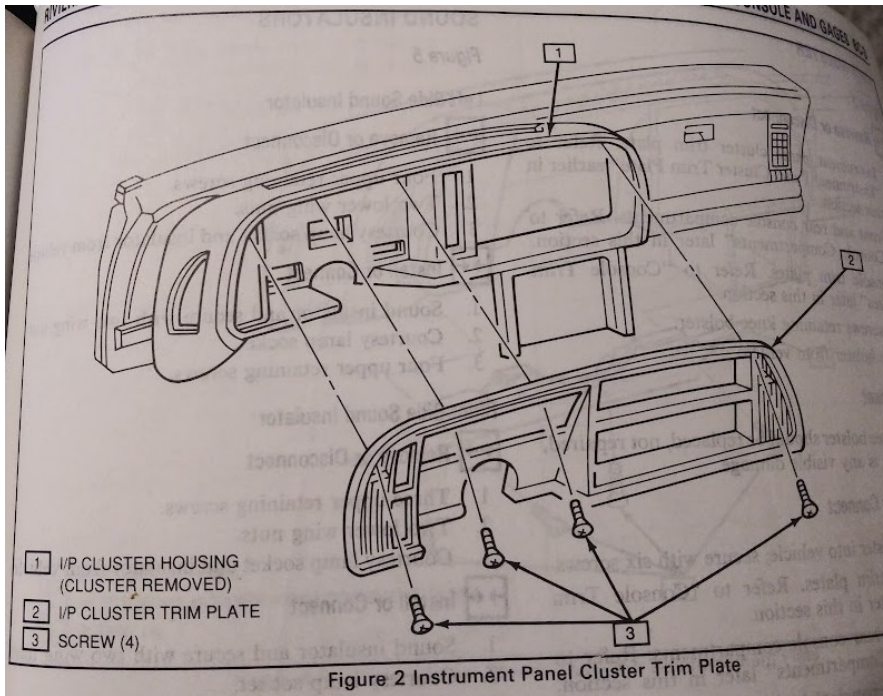

### 3. Remove the Knee Bolster

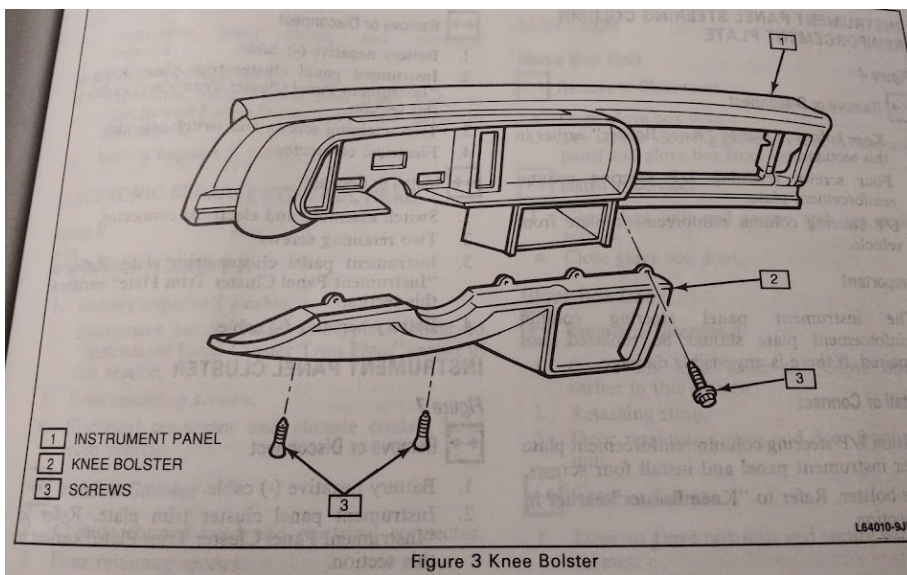

#### 4. Remove the Steering Column Reinforcement plate

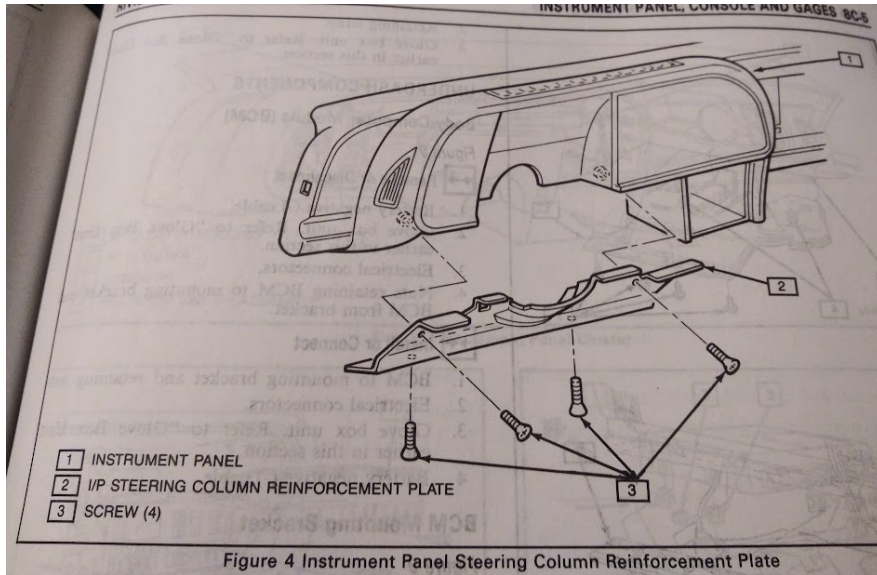

5. Make sure the steering wheel is locked in the centered position. This is important to make sure the air bag coil does not get out of alignment.

6. Remove Air Bag by loosening the 4 T27 screws from behind steering wheel, then disconnecting the yellow Air Bag plug. Place the air bag in a safe place face up.

7. Using a steering wheel puller kit (you can rent at pretty much any auto parts store) Pull the steering wheel.

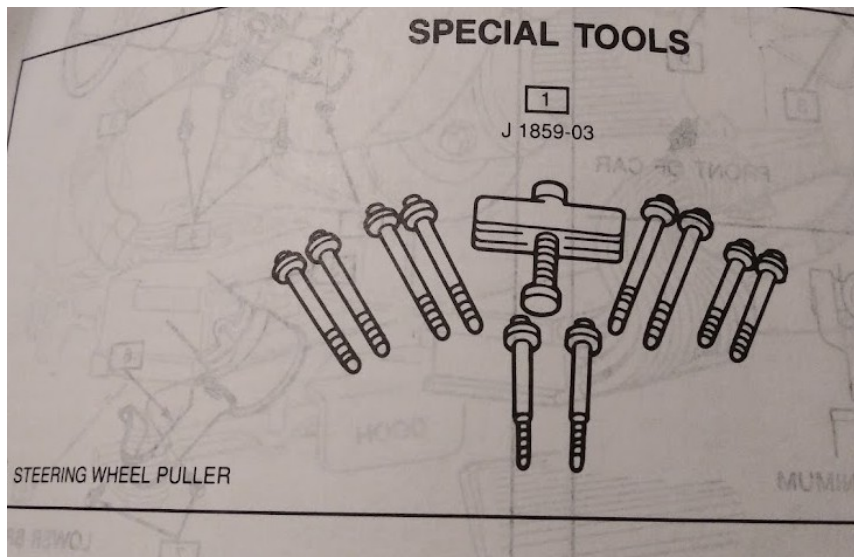

8. Remove the C ring holding the Air bag Coil and remove the coil (items 2 and 3 in Steering column Assembly). Just let the coil hang by the wire.

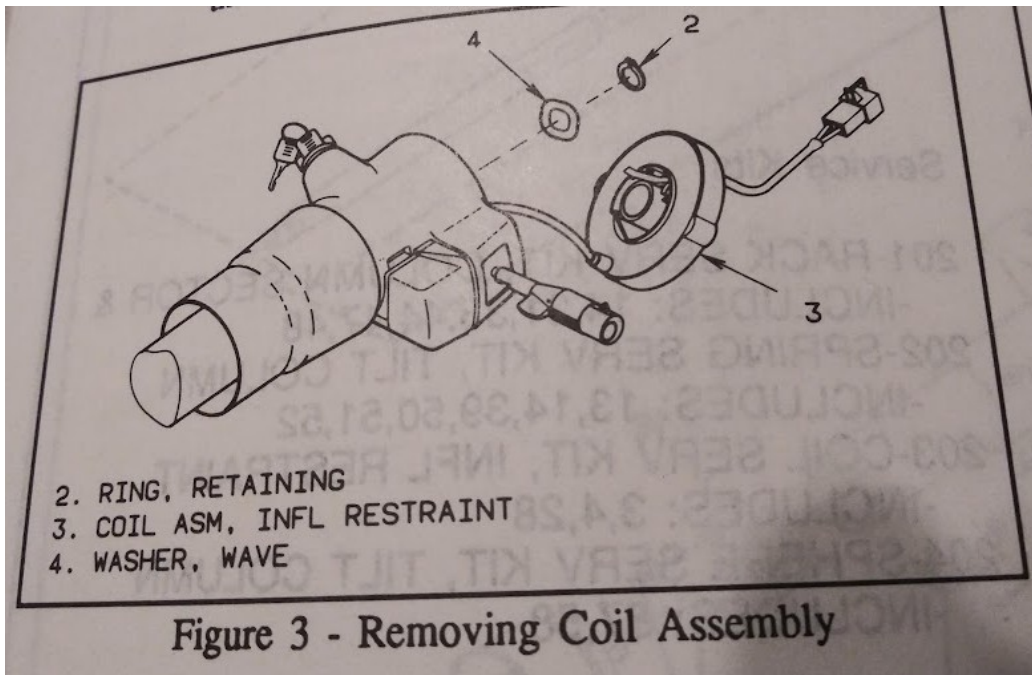

9. Remove the spring washer (item 4)

10. You then need to use the U bracket and the appropriate attachment screw (should be included in the steering wheel kit that you rented) to press the lock shaft (item 6) and spring (item 8) in so you can remove the retaining ring (item 5). This is the hardest part. I used some needlenose pliers and a small hook to get the retaining ring off.

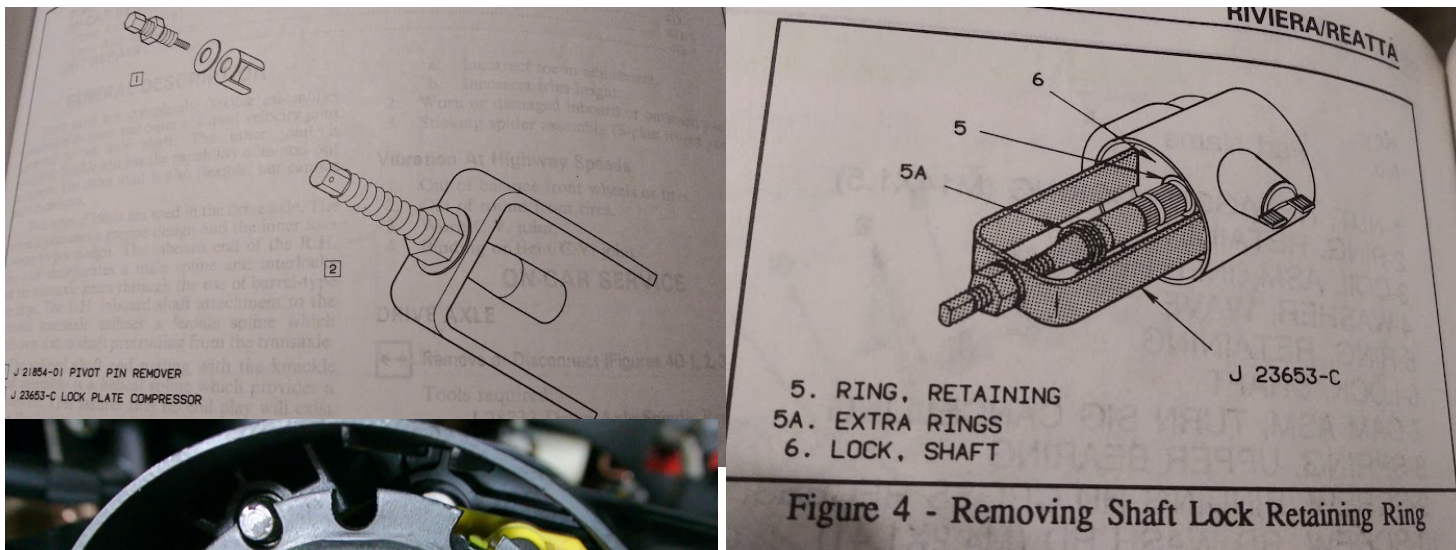

11. remove the turn signal cam (item 7) and spring.

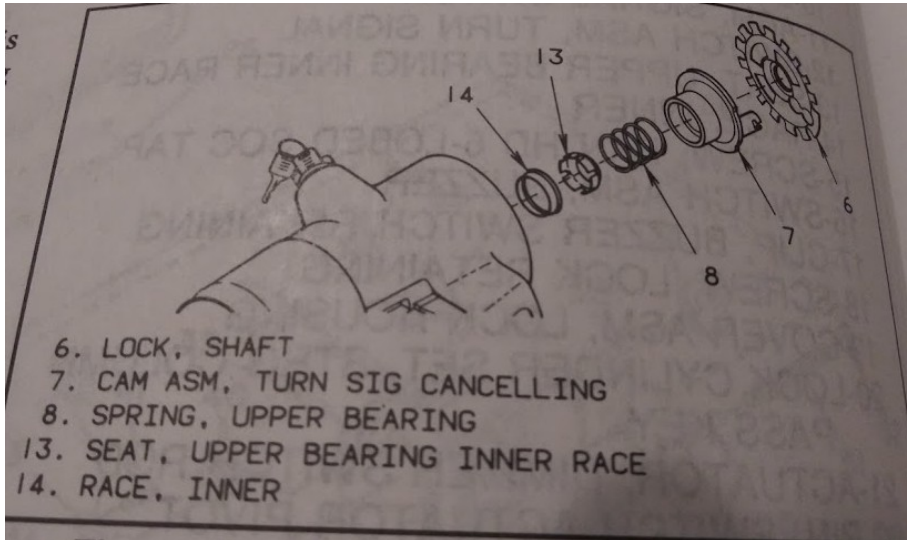

12. Use a philips head screwdriver to remove the Hazzard switch from the steering column.

13. Remove the two screws holding the turn signal switch arm (item 11) and remove the arm.

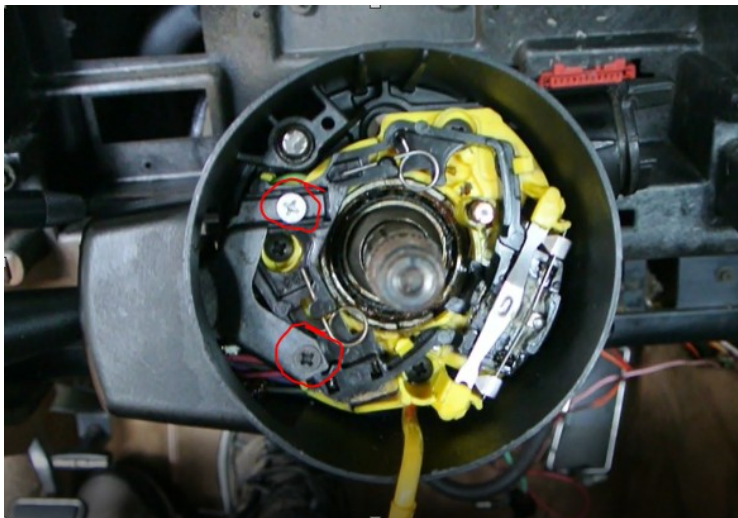

14. Remove the 3 screws holding the turn signal switch (item 12) and remove the switch. I just cut the wires to pull it out. The plug is too big to feed through easily.

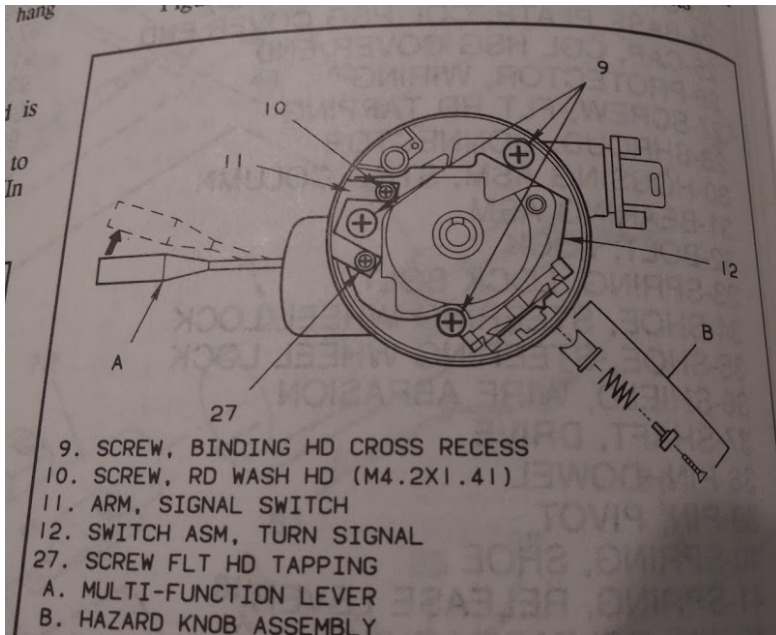

15. Locate Connector 202 and disconnect. It is the large connector located behind the hood release lever and is held together by a bolt.

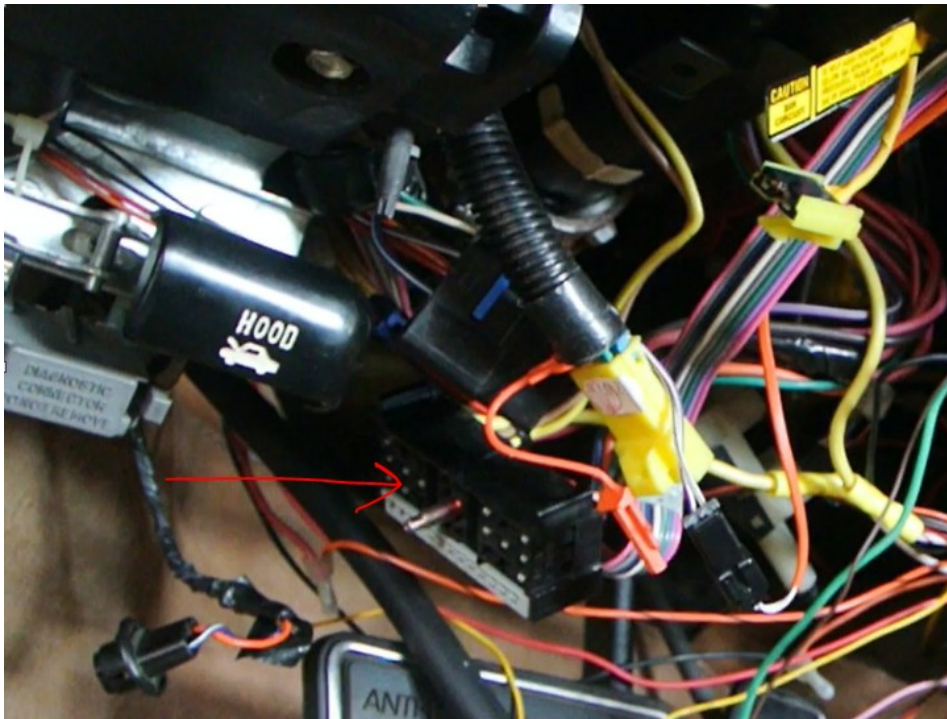

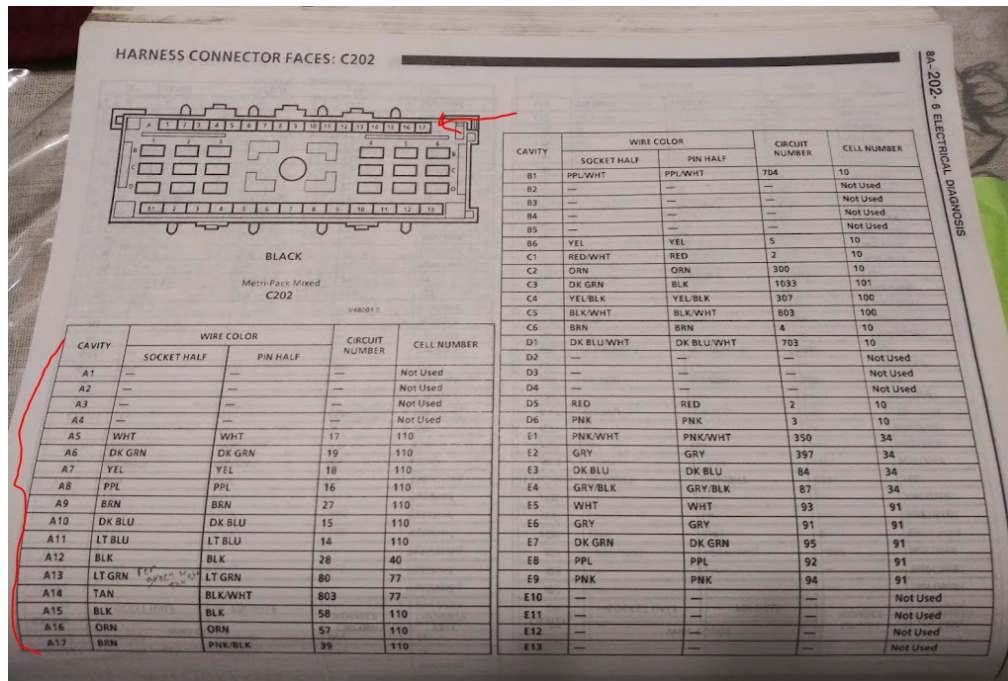

16. remove the terminal block from the turn signal switch from Connector 202 and then pull the rest of the wires that you cut out from the steering column.

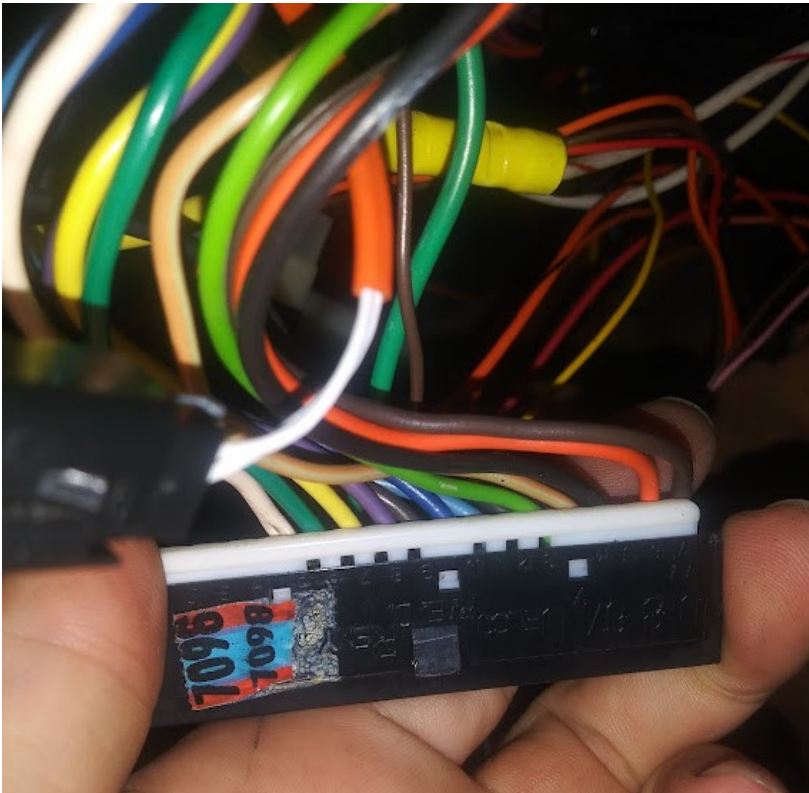

17. Installing the new switch is pretty easy. The hard part is feeding the new wiring through. What I did was take a picture of the location and order of the terminals in the terminal block and then removed them all from the block. you can use either a very small screwdriver to remove the terminals. You have to slide it in between the terminal and the hole of the plastic terminal block to release the tab.

What I found worked really well was one of those pins that you get with a cell phone for opening the sim card tray. Once I got all the terminals out, I taped them all together with electrical tape in as narrow a fashion as I could and then it was not too difficult to feed through the steering column. It helps to remove the plastic wiring protector (item 26) first. Once through remove the electrical tape and then plug all the terminals back into the terminal block.

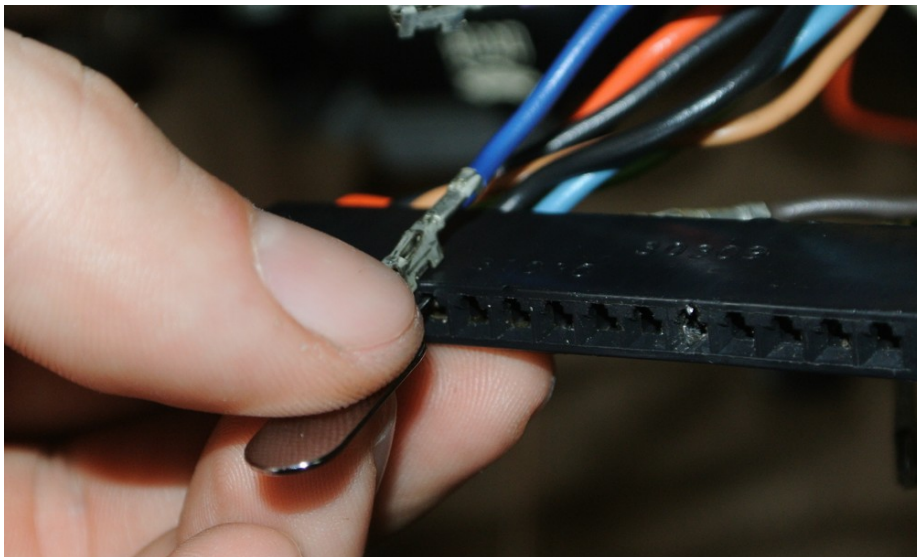
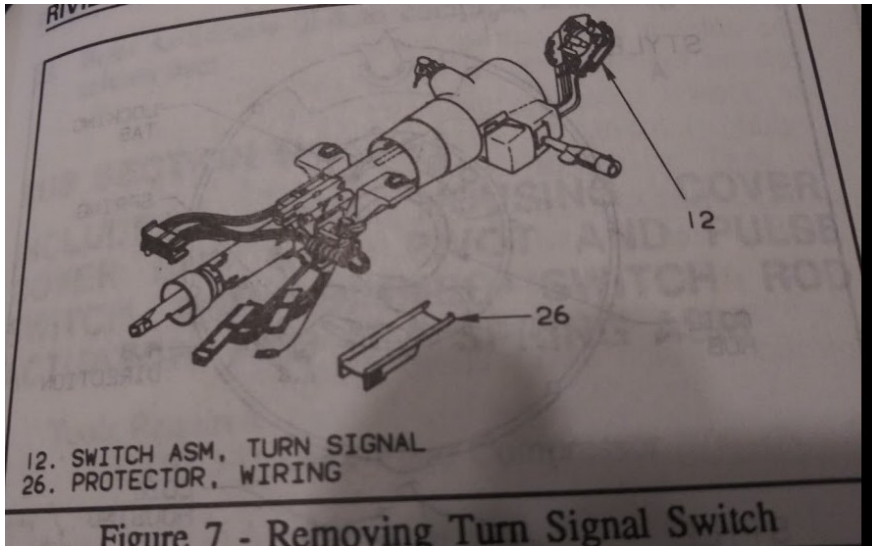

Removing terminals from terminal block.

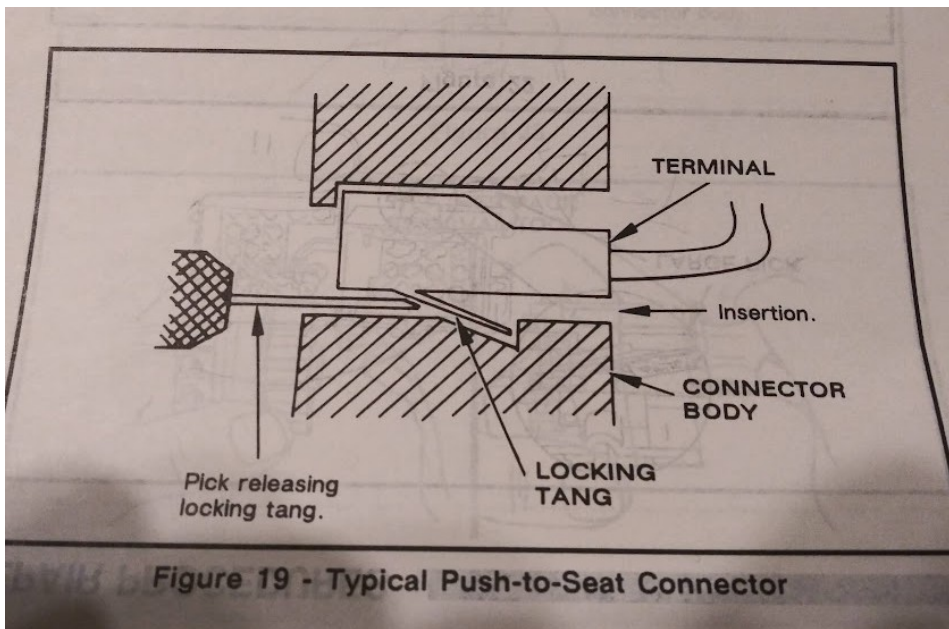

18. Insert terminal block back into connector 202 (be sure of proper orientation).

19. reconnect Connector 202.

The rest is pretty much the reverse of the removal. I found assembly easier than disassembly. Once you get the air bag back on, reconnect the batter to test that it works before you re-assemble the trim.



# Complete Steering Column Assembly:

